

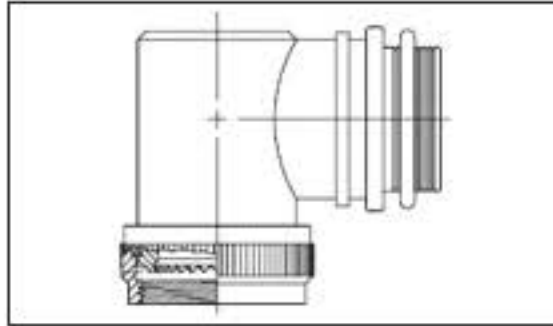

## TXR61AB90-1808AI Product Details

[Share](#) | [Print](#) | [Email](#)

TXR61AB90-1808AI

TE Internal Number: 236607-000

 [Active](#)

### Braid, Fixed, Spin and Tinel Lock Adapters

[Not EU RoHS or ELV Compliant](#)

#### Product Highlights:

- Applies To Cable
- Style = Tinel Lock
- Connector Code = 61
- 90°
- Shell Size = 18, F

[View all Features](#)

#### Quick Links

- ▶ [Check Pricing & Availability](#)
- ▶ [Search for Tooling](#)
- ▶ [Product Feature Selector](#)
- ▶ [Contact Us About This Product](#)

[Add to My Part List](#)  [Request Sample](#)  [Find Similar Products](#)  [Buy Product](#)

#### Documentation & Additional Information

##### Product Drawings:

- [Tinel-Lock Adapter](#) (PDF, English)

##### Catalog Pages/Data Sheets:

- None Available

##### Product Specifications:

- None Available

##### Application Specifications:

- None Available

##### Instruction Sheets:

- None Available

##### CAD Files:

- None Available

##### Additional Information:

- [Product Line Information](#)

##### Related Products:

- [Tooling](#)

[List all Documents](#)

#### Product Features (Please use the Product Drawing for all design activity)

##### Product Type Features:

- [Style](#) = Tinel Lock
- [Angle](#) = 90°
- [Shell Size](#) = 18, F
- Finish = Cadmium Plating over Electroless Nickel
- Material = Aluminum Alloy
- Color = Olive Drab

##### Electrical Characteristics:

- [Entry Size](#) = 8
- [Boot Diameter \(mm \[in\]\)](#) = 20.32 [0.800]
- [Entry Diameter \(mm \[in\]\)](#) = 12.70 [0.500]
- Finish Code = B

##### Body Features:

- [Connector Code](#) = 61
- [Cable Diameter \(Max.\) \(mm \[in\]\)](#) = 12.19 [0.480]

##### Configuration Features:

- [Braid](#) = Single 36 AWG Braid
- Material Code = A

##### Industry Standards:

- [RoHS/ELV Compliance](#) = Not ELV/RoHS compliant
- [Lead Free Solder Processes](#) = Not relevant for lead free process

##### Conditions for Usage:

- Applies To = Cable

##### Other:

- Brand = Raychem

#### Corporate Information

[Who We Are](#)  
[Investors](#)  
[News Room](#)  
[Supplier Portal](#)  
[Careers](#)

#### Quick Links

[Check Distributor Inventory](#)  
[Cross Reference](#)  
[Find Documents & Drawings](#)  
[Product Compliance Support Center](#)  
[Site Map](#)

#### Customer Support

[Email or Chat With Us](#)  
[Find a Phone Number](#)  
[Search Knowledge Base](#)  
[Manage your Account](#)

#### Keep Me Informed

Receive TE News, Events & Technology Updates

[>](#)

